

**MATRIX**  
STEEL

# Metal Fascia

FASCIA AND BARGE

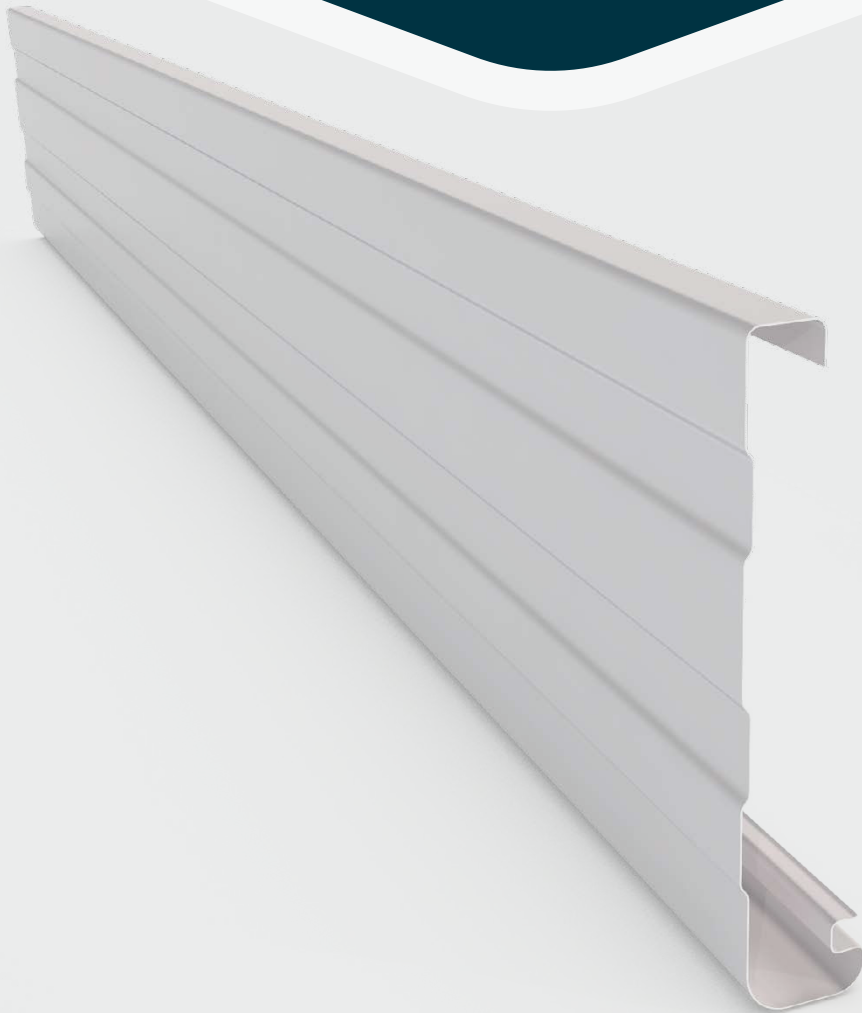

[matrixsteel.au](http://matrixsteel.au)

Make it a  
MATRIX.

# Metal Fascia

## OVERVIEW

<b>Material</b>	Colorbond® or Zinalume®
<b>Gauges</b>	0.42 BMT G550
<b>Useage</b>	Soffit, Fascia, Barge

## INSTALLATION

### Principle

Once the roof trusses and rafters have been assembled the metal fascia is then installed, ready for the gutter to be added. The rafter brackets have been specially designed to aid quick assembly, with slots for both horizontal and vertical adjustment, as well as holes for screwing to timber and metal rafters. It is not necessary to cut the end of the rafters.

### Recommended Fasteners

Brackets to timber rafters: no 6 x 25 blue head type 17 self drilling screws. For steel 10 x 16 teks minimum 3 fasteners per bracket are required.

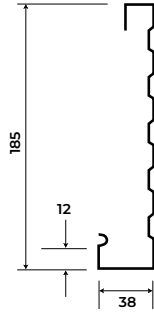

## PROCEDURE

### Principle

Work on each straight run in turn.

1. Mark the position of the brackets on the two end rafters.  
Note: The top of the fascia should be located as follows: metal roofs - 2mm (min) below the roof sheeting. Tile roofs 35 to 65mm above the top corner of the rafter.
2. Run a stringline between the two end rafters on the vertical line. (String not to touch other rafters).
3. Mark vertical lines on the other rafters using a bevel set at the roof pitch.
4. Fix 2 rafter brackets to the end rafters on the marked lines.
5. Run a stringline between these brackets attaching at the soffit groove on each.
6. Add intermediate brackets, sufficient to support the fascia. These must be on the vertical lines and the stringline.
7. Cut the length of fascia on the ground. Prepare mitres and splices if required.
8. Lift the prepared length of fascia up to the brackets, hook the bottom onto the brackets, and spring the top over the top of the brackets.
9. Add the remaining brackets. Twist the brackets into the back of the fascia, slide along and hold against rafter. Screw to the rafter, ensuring the fascia is straight and the front face is vertical.

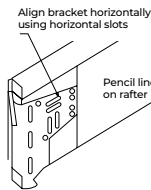
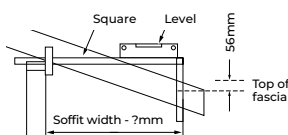

## BARGE

Install Barge in a similar manner to Fascia. Except the Brackets are bent at right angles along the line of slots. In this case all brackets are fixed on and the barge sprung on last. Methods of fixing barge are as follows:

### Option 1

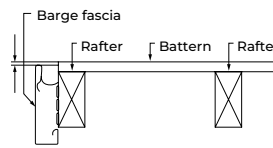

### Option 2

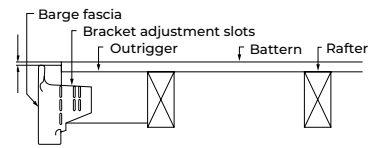

### Option 3

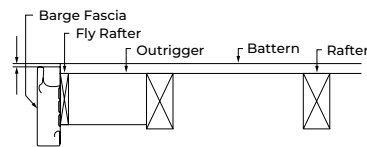

Cut both ends of the barge at an angle to suit the pitch of the roof. A Barge mitre is used to finish the joint between the barge and the Fascia. At the roof apex the 2 Barge lengths are joined by leaving a flange on one which inserts into the other and is secured by blind rivets.

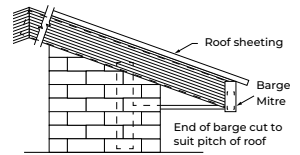

## FITTING ACCESSORIES

### Joining Sleeves

Slide one end of the internal joining sleeve into one length, and then slide the second length over the other end.

### Fascia Corners

The internal mitre and internal mitre angle are used to form internal corner joints and are fixed with blind rivets. External corners can also be made using the external mitre. Alternatively, mitre the length of fascia/ barge, bend to 90o and secure with blind rivets.

### Maximum Support Spacings (Non Cyclonic)

Metal fascia shall be supported by a bracket at every rafter, or at a maximum of 1200mm between brackets.

**NOTE: FOR CYCLONIC REGIONS REFER TO YOUR LOCAL MANUFACTURER**

## FIXING FASCIA COVER

Fascia Cover is used to cover old timber fascia and is simply placed over the timber fascia and fixed with a pan head screw at each rafter. The same accessories as for Barge can be used to finish off.

## SOFFIT APPLICATION

Metal fascia is installed exactly level, and the height and distance from the wall can be adjusted so that standard width soffit lining can be used without any trimming. The groove in the rear of the metal fascia is used to retain the outer edge of the soffit lining, and thus there is no trim piece required.

## ACCESSORIES

- A Standard Rafter Bracket
- B Internal Mitre
- C Internal Mitre Angle
- D Internal Joining Sleeve
- E External Joining Sleeve
- F External Mitre

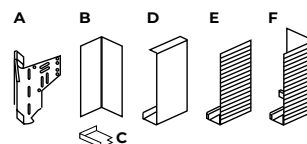

## BARGE

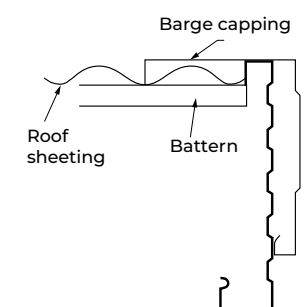

# Why make it a Matrix?

Matrix Steel provides a full range of products for all building projects – commercial or residential. Locally manufactured products using only genuine BlueScope Steel in COLORBOND® colours, you can trust a Matrix Steel purchase.



## SUPPLY AND FIT

As specialists in all things steel, we can assist with your entire project from start to finish. From ideas to advice, installation and everything in between, Matrix Steel offers a full range of services to make projects a breeze.



## FREE EXPERT ADVICE

Not sure where to start? Our trained experts can answer any questions, no matter how big or small. You can call your local Matrix Steel team for advice, or request a free quote anytime.



## SUPERIOR QUALITY AND PERFORMANCE

Manufactured right here in Australia from only the best BlueScope Steel, our tried and tested products are guaranteed to last well into the future.

**Ph. 1300 GO MATRIX (1300 466 287)**  
[matrixsteel.au](http://matrixsteel.au)

# MATRIX STEEL

Ph. 1300 GO MATRIX (1300 466 287)  
[matrixsteel.au](http://matrixsteel.au)

## GLADSTONE

94 Hanson Road,  
Gladstone

## BUNDABERG

73 Princess Street,  
Bundaberg

## GYMPIE

3/23 Pinewood Ave,  
Gympie

## HERVEY BAY

1/83 Beach Road,  
Hervey Bay

## SUNSHINE COAST

17 Fishermans Road,  
Maroochydore

## BRISBANE

1 Robart Court,  
Narangba

## LISMORE

9-11 Habib Drive,  
South Lismore

Make it a MATRIX.